

Overview

In the transmission line, the socket clevis plays the role of suspending the insulator string and the suspension clamp, and bears greater working stress. Its safety performance is very important to the transmission line.

The bowl head hanging plate is made of malleable cast iron or forged parts, and the steel parts are hot-dip galvanized. The locking pin is made of bronze or stainless steel.

Socket Clevis classification: W Socket clevis, WJ Socket clevis, WS Socket clevis, WSJ Socket clevis

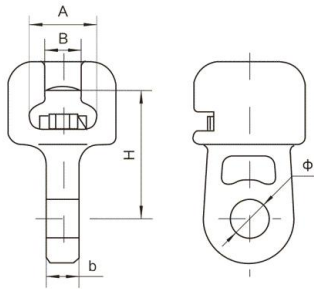

W SOCKET CLEVIS

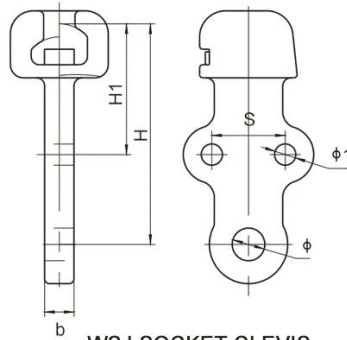

WSJ SOCKET CLEVIS

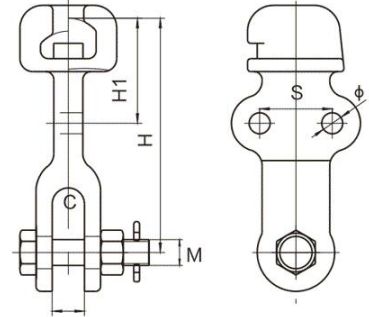

WJ SOCKET CLEVIS

Parameter

W Socket clevis

Stable design Catalog No.	Catalog No.	Main Dimensions(mm)					Designated	Specified	Weight
		Ø	b	H	A	B	size of coupling	Failure Load (kN)	(kg)
	W-7A	20	16	70	34.5	19.2	16	70	0.8
	W-7B	20	16	115	34.5	19.2	16	70	0.92
	W1-10	20	18	85	34.5	19.2	16	100	0.9
	W1-12	24	20	85	34.5	19.2	16	120	1.3
	W-30	39	32	110	51	27.5	24	300	3.5
W-0770		20	16	70	34.5	19.2	16	70	0.8
W-07115		20	16	115	34.5	19.2	16	70	1
W-1085		20	16	85	34.5	19.2	16	100	1.1
W-1290		24	16	90	34.5	19.2	16	120	1.3
W-1695		26	18	95	42.5	23	20	160	1.9
W-32110		33	28	110	51	27.5	24	320	4.2

WSJ Socket clevis

Stable design Catalog No.	Main Dimensions(mm)						Designated	Specified	Weight
	C	M	Ø	H	H1	S	size of coupling	Failure Load (kN)	(kg)
WSJ-07145	20	16	13	145	65	45	16	70	1.9
WSJ-10145	20	18	13	145	65	45	16	100	2
WSJ-12160	20	22	13	160	70	45	16	120	2.2

WJ Socket clevis

Stable design	Main Dimensions(mm)						Designated	Specified	Weight
							size of	Failure Load	(kg)
Catalog No.	b	H	H1	∅	∅1	S	coupling	(kN)	
WJ-07135	16	135	80	20	13	45	16	70	1.5
WJ-10135	16	135	80	20	13	45	16	100	1.5
WJ-12135	16	145	80	24	13	45	16	120	1.6

WS Socket clevis

Stable design	Catalog No.	Main Dimensions(mm)					Designated	Specified	Weight
							size of	Failure Load	(kg)
Catalog No.						coupling			
		C	H	M	A	B		(kN)	
	WS-7	18	70	16	34.5	19.2	16	70	0.97
	WS-10	20	85	18	34.5	19.2	16	100	1.7
	WS-12	24	85	22	34.5	19.2	16	120	3.81
	WS-16	26	95	24	42.5	23	20	160	2.6
	WS-21	30	100	27	51	27.5	24	210	4.3
	WS-20D	30	100	27	42.5	23	20	200	4.3
	WS-30	36	110	36	51	27.5	24	320	5.7
WS-0770		20	70	16	34.5	19.2	16	70	0.97
WS-1085		20	85	18	34.5	19.2	16	100	1.7
WS-1290		20	90	22	34.5	19.2	16	120	1.7
WS-1695		22	95	24	42.5	23	20	160	2.6
WS-21100		24	100	24	42.5	23	20	210	3.8
WS-25100		28	100	27	51	27.5	24	250	4.3
WS-32110		32	110	30	51	27.5	24	320	5.7